

Ground Floor

Approx. 59.3 sq. metres (638.2 sq. feet)

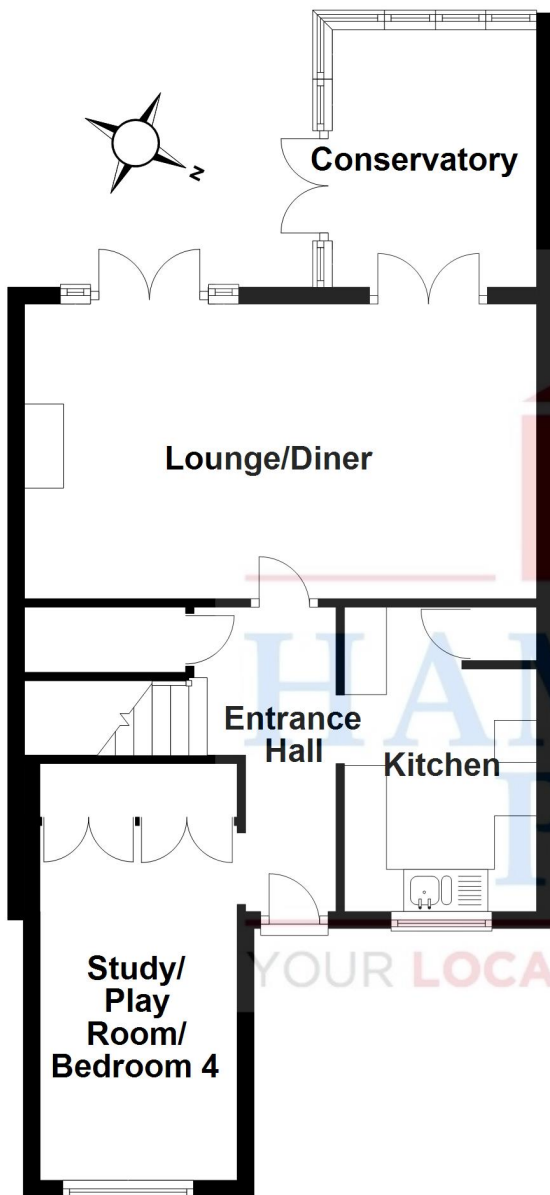

First Floor

Approx. 43.9 sq. metres (472.6 sq. feet)

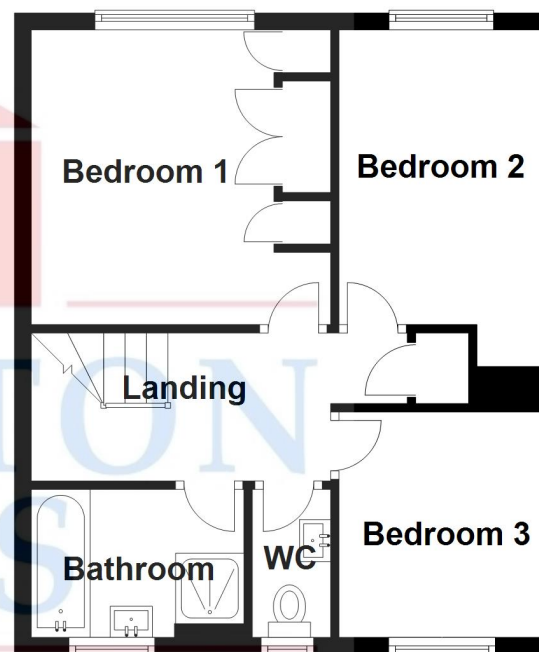

Total area: approx. 103.2 sq. metres (1110.8 sq. feet)

This plan is for layout guidance only and is NOT TO SCALE
Check all dimensions, shapes & compass bearing before making any decisions reliant upon them.
Copyright Hamilton Piers

Plan produced using PlanUp.